

Označení dílů

M - fotoleptané kovové díly
D - obtisky
W - drát

Parts labelling

M - photoetched parts
D - decals
W - wire

Poznámka - Pro čiré zasklení je možné folii v oknech po vlepění umýt štetcem navlhčeným vodou
Notice - You can wash foil in windows by water moistened brush for pellucid windows

Návod ke stavbě

Při stavbě postupujte podle instruktážních obrázků.

Instructions

Follow the instruction drawings the assembly.

Upozornění:Během opracování může vznikat prach, který může dráždit dýchací cesty. Používejte ochranu očí při odšťihování kovových dílů.

Notice:Machining can produce dust witch can be irritating to the respiratory tract. Metal parts should be cut off using protection eyesight.

Kupujte přímo na www.plusmodel.cz
Buy directly from www.plusmodel.cz

Plus Model s.r.o
Jižní 56, 370 10 České Budějovice
Czech Republic
<http://www.plusmodel.cz>
e-mail: plusmodel@plusmodel.cz

485

plusmodel

1/35

Hanomag RL - 20

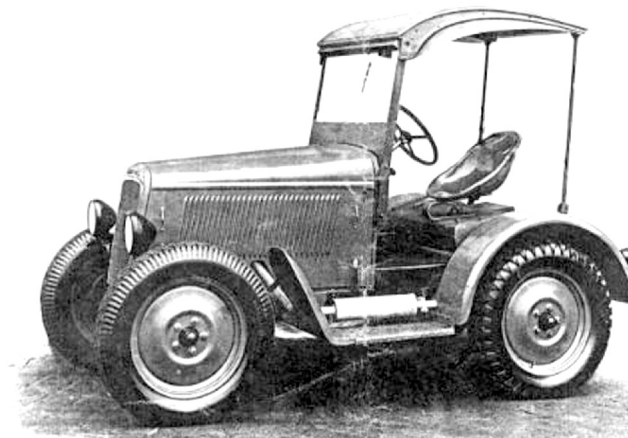

Historie

Traktor Hanomag RL-20 byl určen jako silniční tahač. Firma Hanomag vyráběla tento typ v letech 1937 až 1942 v celkovém počtu 4320 kusů. Traktor měl čtyřválcový diesellový motor o výkonu 14 kW / 19,8 PS a obsahu 1911 cm³. Byl osazen čtyřstupňovou převodovkou. Celková váha 1615 kg. Maximální rychlost byla 24 km/h. Mnoho těchto traktorů bylo po začátku války převedeno do služby v německé armádě.

Zbarvení a kamufláž

Varianta I: Celé vozidlo je v barvě Panzer grau. Volant a filtr sání v černé barvě. Hlava motoru a nádrž paliva v hliníkové barvě.

Varianta II: Celé vozidlo v modré barvě. Středky kol v červené barvě. Volant, světla, blok motoru, nádrž paliva, chladič v černé barvě. Hlava motoru hliníková.

History

Hanomag RL-20 tractor was a road towing vehicle. Hanomag company produced this vehicle from 1937 to 1942 and 4,320 units were built. The tractor was fitted with a 4-cylinder diesel 1,911 cm³ engine of 14 kW / 19,8 HP output, and a 4-speed gear. The total weight was 1,615 kilo and the max. speed was 24 km/h. At the beginning of WWII a lot of these tractors were put into service with the German army.

Camouflage and colours

Option I: The vehicle is in Panzer Grau overall. The steering wheel and the air filter is in black. The engine cylinder head, and the fuel tank in aluminum colour.

Option II: The vehicle is in blue overall. Wheel hubs are red. The steering wheel, lights, the cylinder block, the fuel tank, and the radiator are black. The engine cylinder head is in aluminum colour.

I.

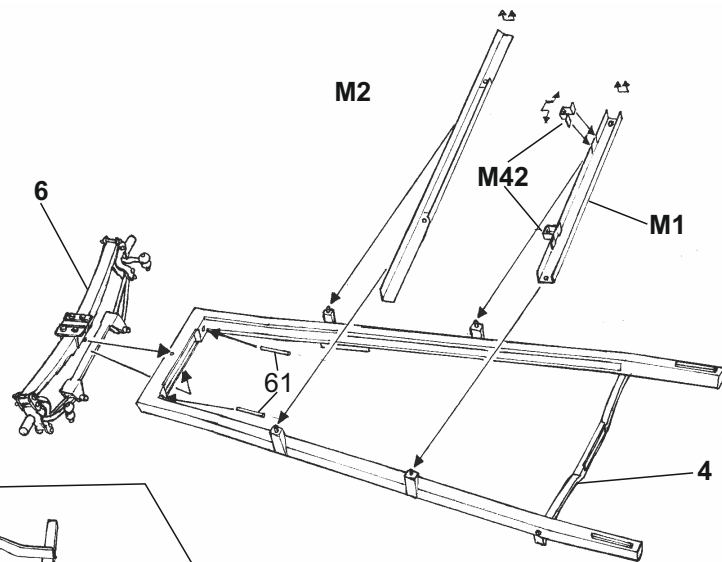

II.

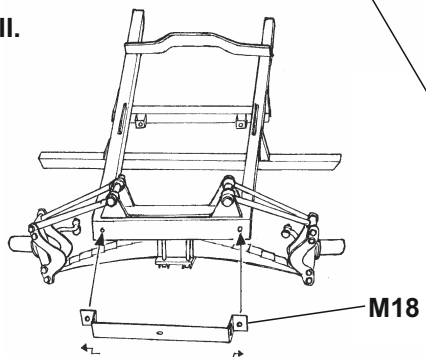

III.

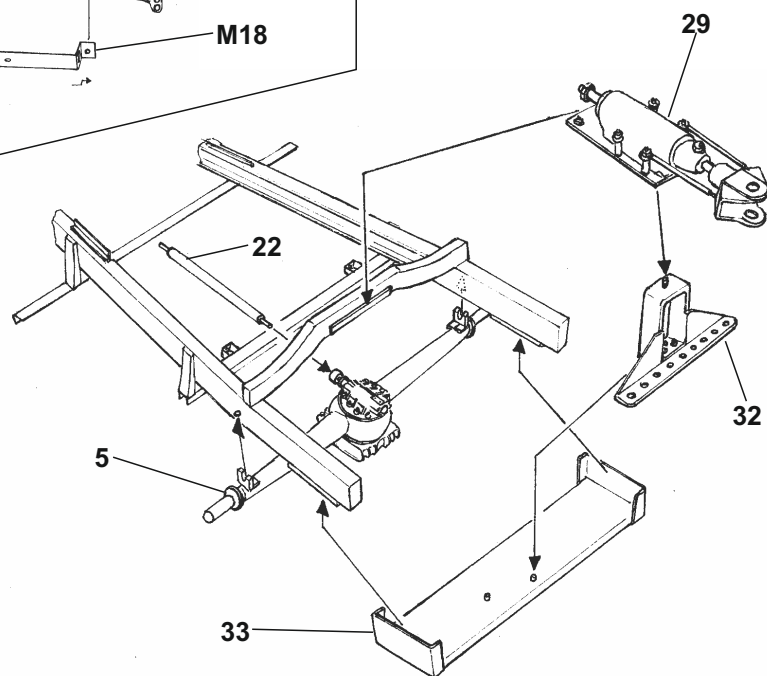

Obtisky / Decals

Varianta I / Variant I

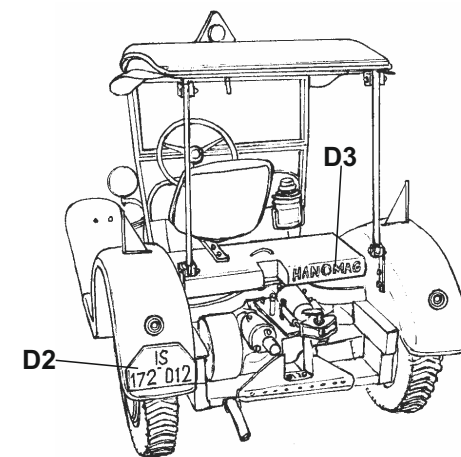
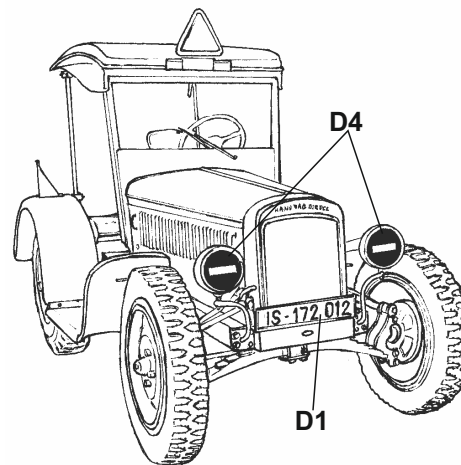

Varianta II / Variant II

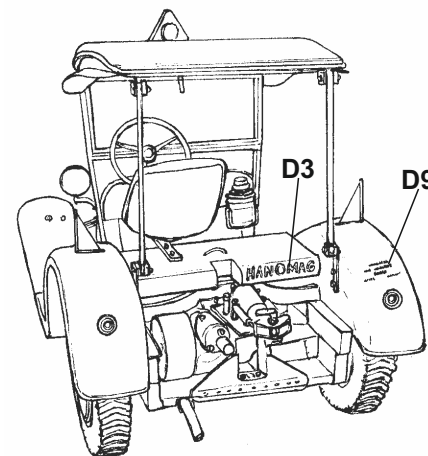

Obě varianty / Both variants

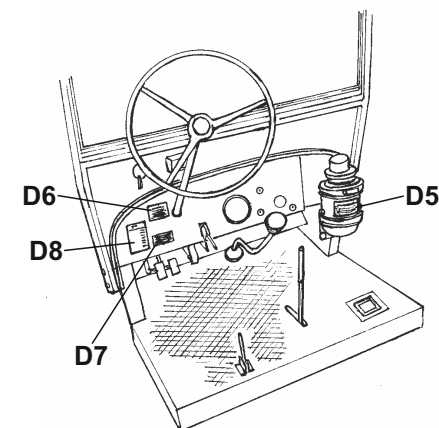

XX.

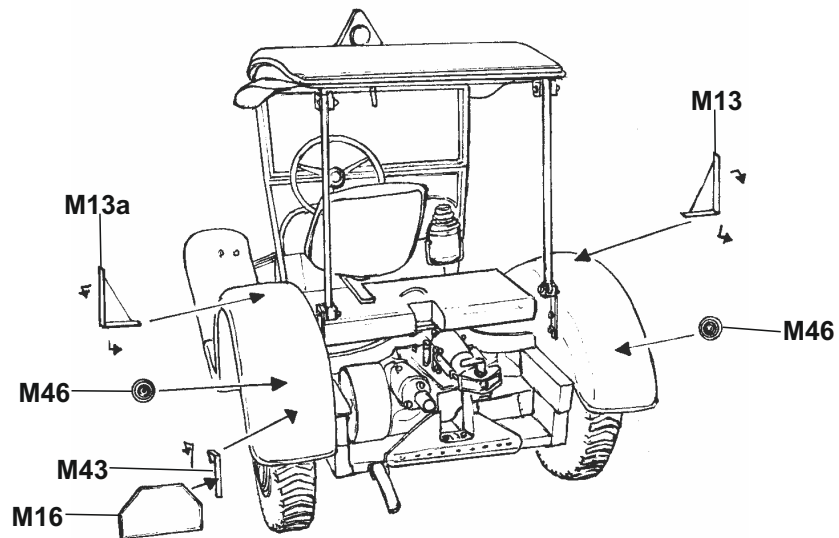

Díly č. M43 a M16 použijte pouze pro variantu I.
 Parts No. M43 and M16 used for variant I only.

XXI.

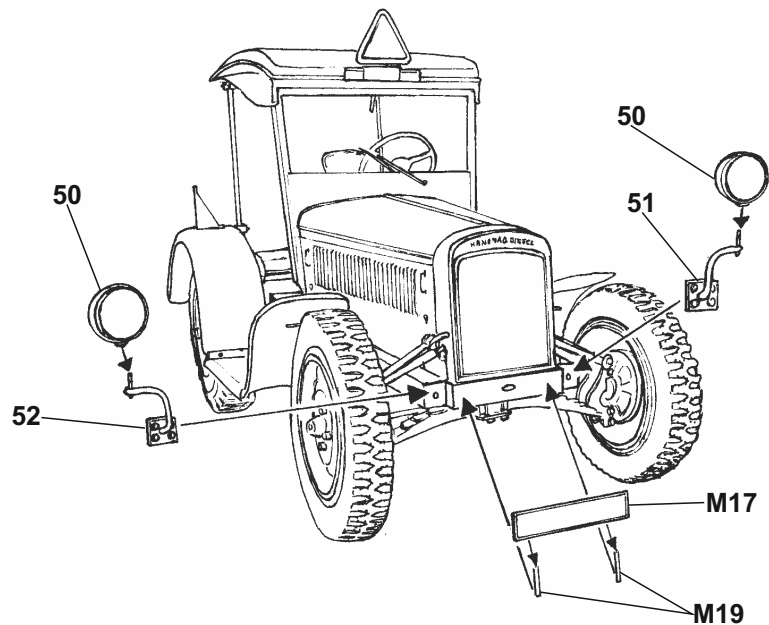

Díly č. M17 a M19 použijte pouze pro variantu I.
 Parts No. M17 and M19 used for variant I only.

IV.

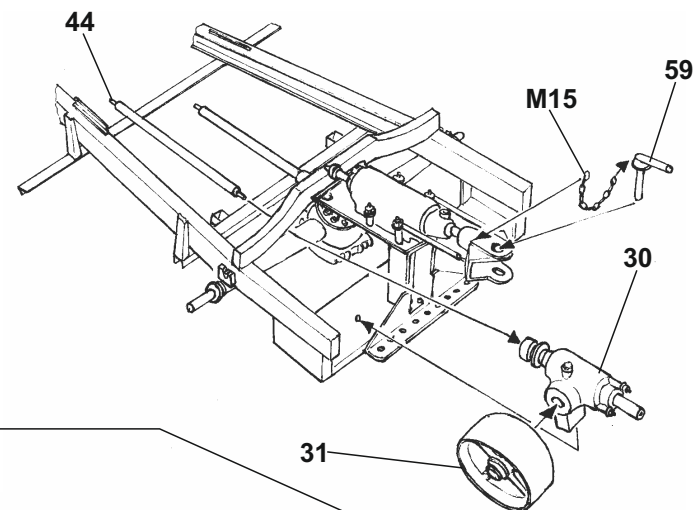

V.

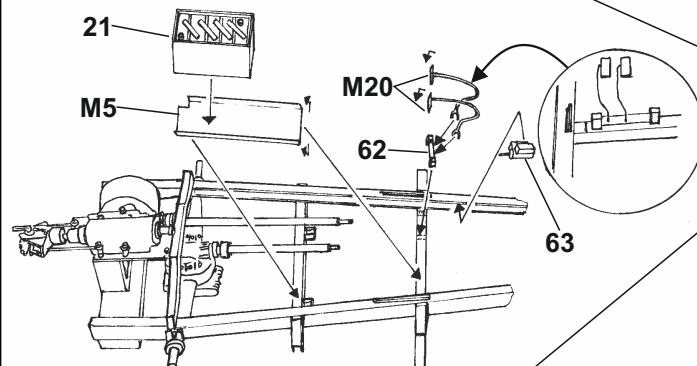

VI.

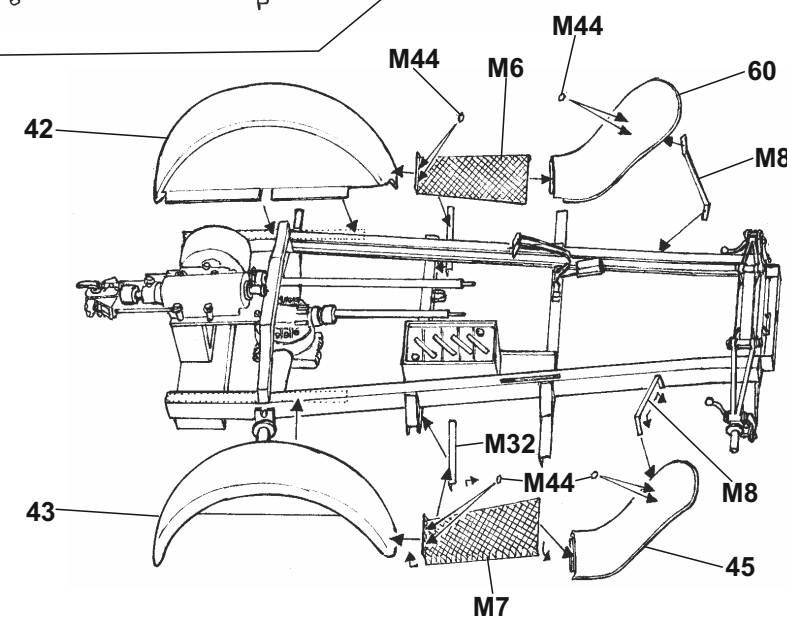

VII.

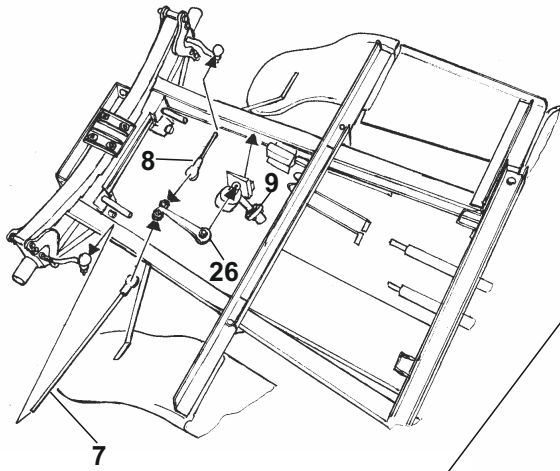

VIII.

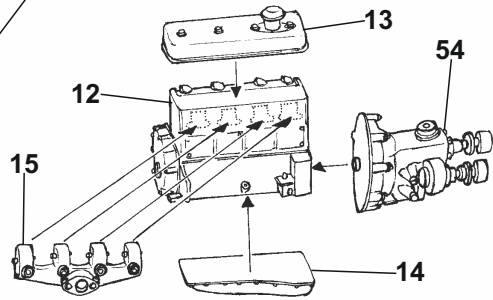

IX.

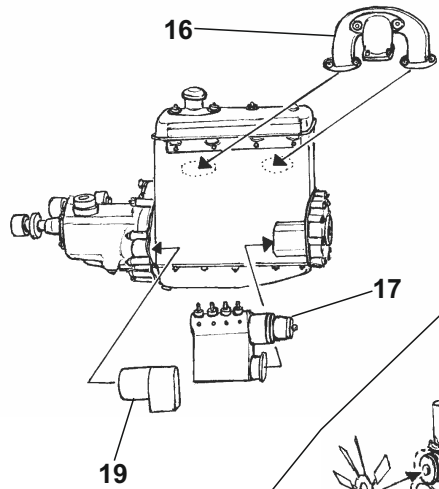

X.

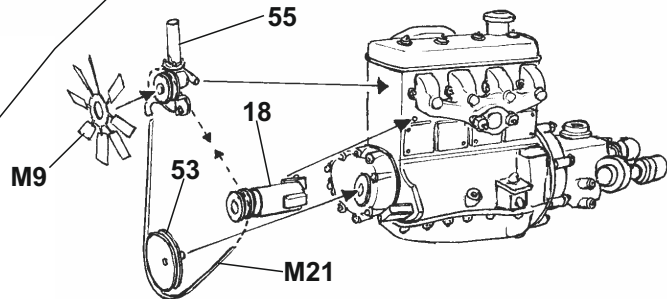

XIX.

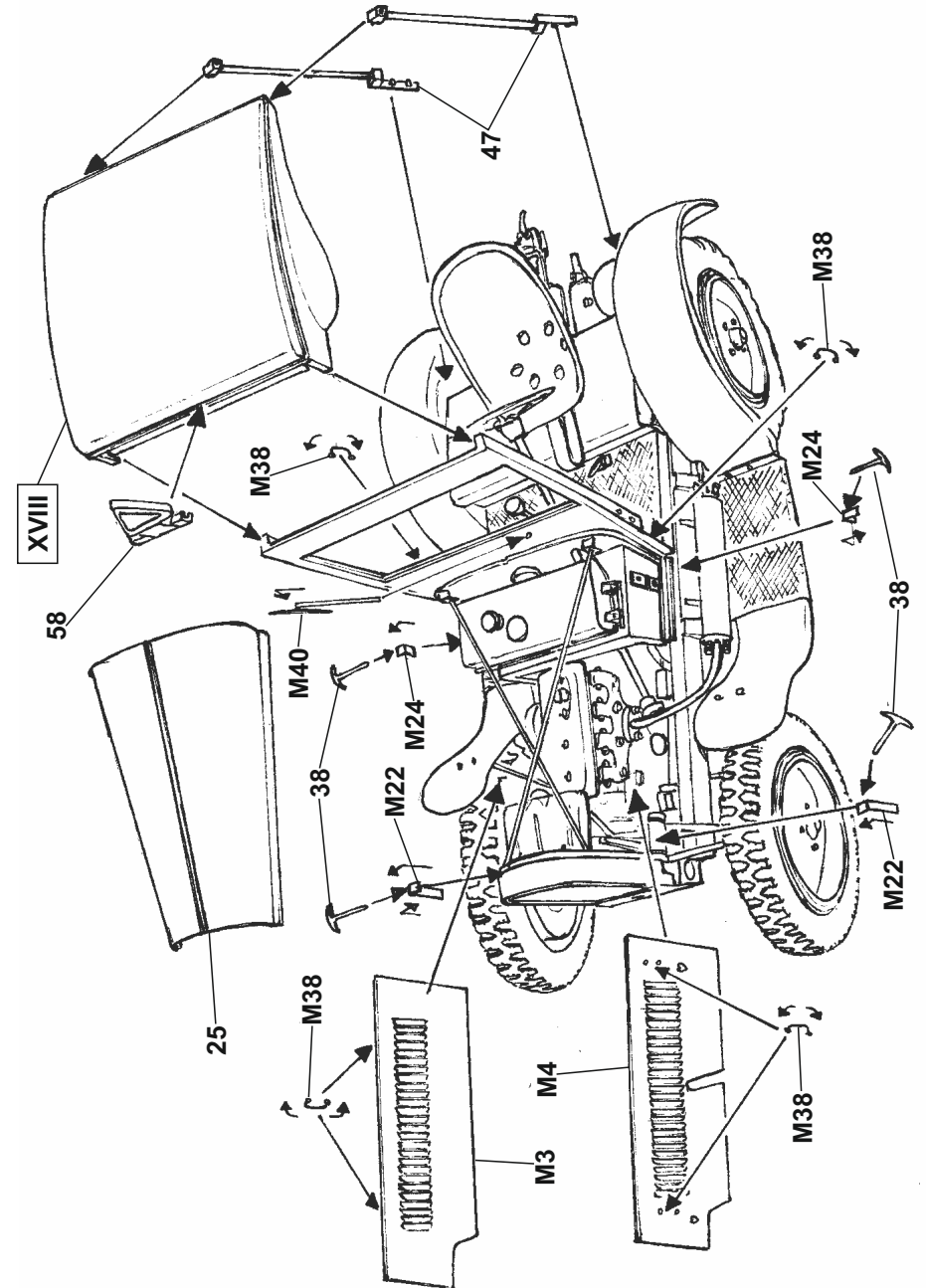

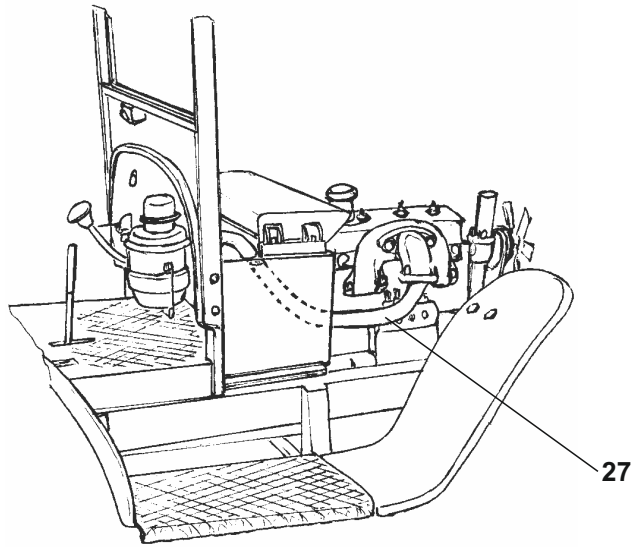

XVII.

27

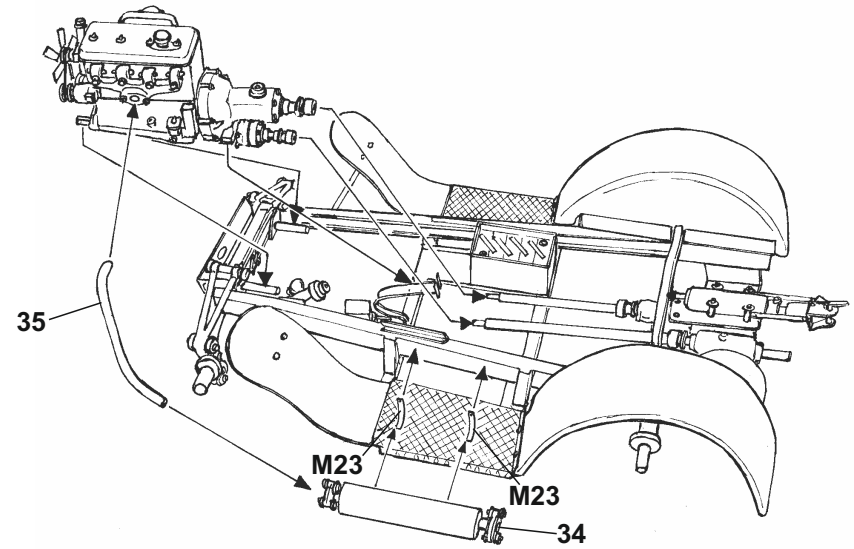

XI.

35

M23

M23

34

XVIII.

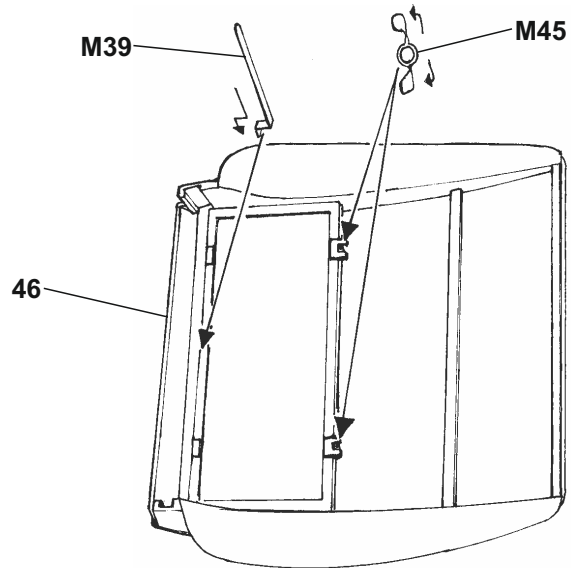

M39

M45

46

XII.

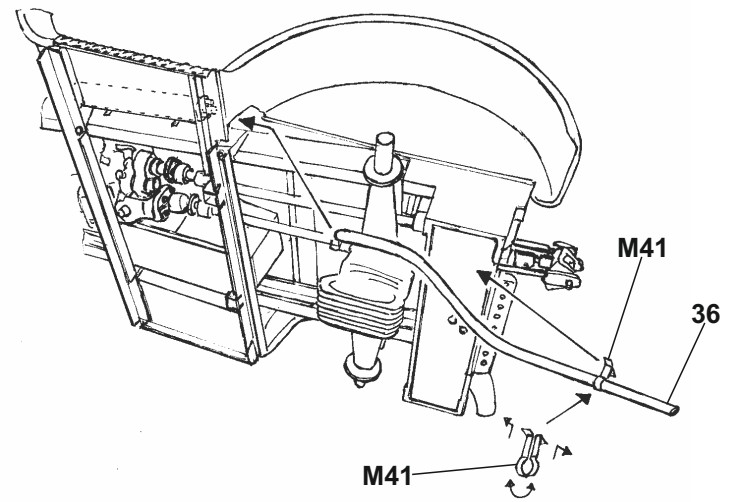

M41

36

M41

XIII.

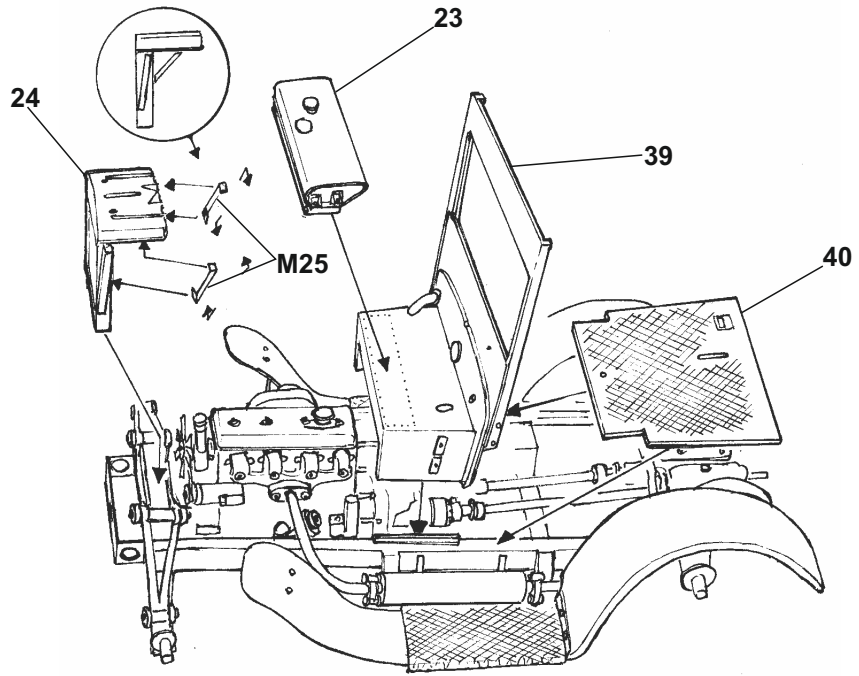

XV.

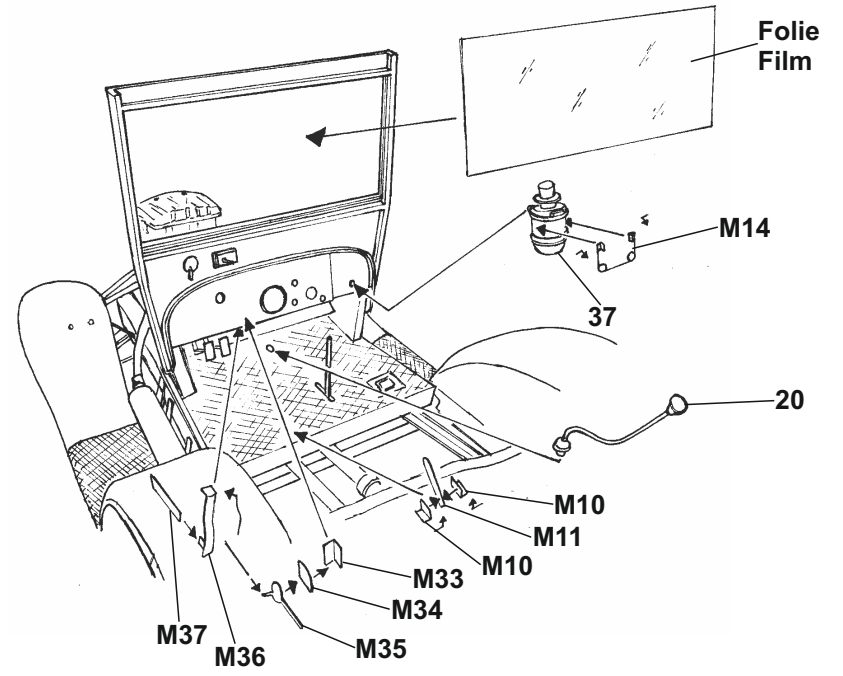

XIV.

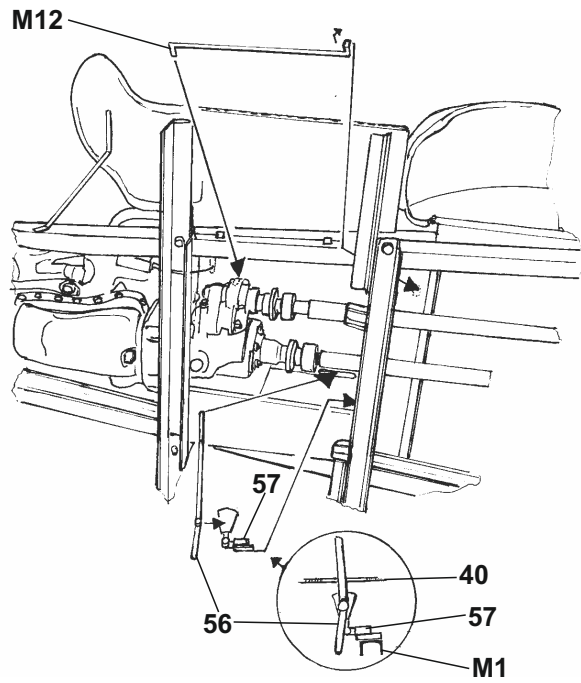

XVI.

